

INSTALLATION MANUAL

45143

Level of Difficulty

Easy

Weight Capacity

Gross trailer weight (GTW)	7,500 lbs.
Tongue weight (TW)	750 lbs.

Parts List

Item	Qty	Description
1	1	Loaded ball mount assembly
2	1	Anti-rattle clamp plate
3	1	Anti-rattle hitch pin
4	1	Clip

Tools Required

Torque wrench	Socket
---------------	--------

Torque Specifications

1" bolt	250 ft-lbs.
1/2" anti-rattle pin	35 ft-lbs.

Use above torque setting unless otherwise noted

Product Registration

CURT Group stands behind our products with industry-leading warranties. Provide feedback and help us to improve our products by registering your purchase at: warranty.curtgroup.com/surveys

WARNING

Never exceed the vehicle manufacturer's recommended towing capacity. The ratings of the trailer ball are intended to represent the capability of the product and in no way reflect the ratings or capacity of the towing system it is being used with. The consumer or operator are strongly advised to know the ratings of the various components of the towing system and never exceed the limits of the lowest rated component being used.

Use of any pin other than what is provided by the manufacturer could be a serious safety hazard and will void the warranty.

Ensure that the safety chains operate freely around the trailer ball system and do not become entangled in the trailer ball system.

When the ball can be moved five degrees or more from a vertical position with minimal force, by hand, the product has reached the end of its useful life and must be replaced. Continued use of a worn trailer ball assembly may result in the trailer becoming separated from the vehicle. Consult CURT customer service if you have any questions.

Periodically check the hex nut and ensure it is tightened to the correct torque specifications.

Before every use, be sure the snap ring on the pivot pin of the trailer ball assembly is in place and properly seated.



Immediately discontinue product use if the snap ring is missing on the end of the trailer ball pivot pin or if the trailer ball pin has backed partially out of the trailer ball assembly.

Product Photo



NOTICE

Before you begin installation, read all instructions thoroughly.

Proper tools will improve the quality of installation and reduce the time required.

Ensure the trailer ball size matches the trailer coupler.

If it does not, the trailer could become uncoupled.

To help prevent damage to the product or vehicle, refer to the specified torque specifications when securing hardware during the installation process.

RockerBall™ should be greased prior to initial use and periodically as described in step 3.

ASSEMBLY

Parts List

Item	Qty	Description
1	1	Loaded ball mount assembly
2	1	Anti-rattle clamp plate
3	1	Anti-rattle hitch pin
4	1	Clip

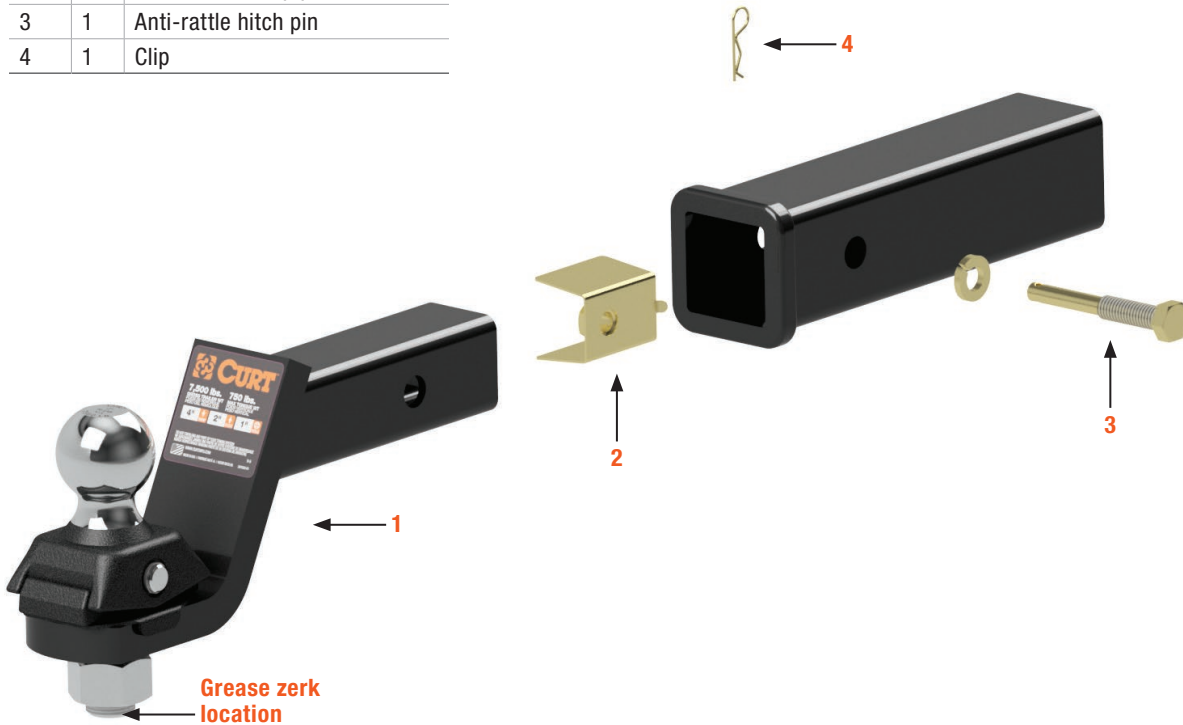

Step 1

Place the anti-rattle clamp plate (#2) inside the hollow ball mount shank and align the nut with the hitch pin hole.

Note: The small tab on the back of the clamp plate may be bent straight to ease installation.

Step 2

Insert the ball mount (#1) into your receiver tube and align with the hitch pin hole in the receiver.

Step 3

Place the supplied lock washer onto the anti-rattle hitch pin (#3) and secure the ball mount by threading the pin completely through the nut in the anti-rattle clamp plate (#2). Tighten the anti-rattle hitch pin to 35 ft-lbs. and insert the clip (#4) through the hole in the exposed end.

⚠ DANGER

Failure to tighten hardware to the specified torque can result in serious injury or death.

Step 4

Grease the trailer ball assembly, using the grease zerk located on the bottom of the RockerBall™ shank. Grease prior to initial use and once every 3 months or 3,000 miles of use with a high-quality molybdenum-based grease.

⚠ DANGER

Failure to grease the trailer ball assembly may lead to failure and can result in serious injury or death.

RockerBall™ is adequately lubricated when grease can be seen in the areas marked below.

